

GENERAL NOTES:
1. ALL DIMENSIONS ARE IN MILLIMETRES.
2. ONLY WRITTEN DIMENSIONS ARE TO BE FOLLOWED.
3. ALL EXTERNAL WALL SHALL BE 200MM. THICK AND INTERNAL WALL SHALL BE 125 MM. THICK.
4. ALL MASONRY WORK WILL BE CARRIED OUT WITH FLY ASH BASED A.A.C. BLOCK.
5. SOLAR, WIND OR OTHER RENEWABLE ENERGY SHALL BE INSTALLED TO MEET ELECTRICITY GENERATION EQUIVALENT TO AT LEAST 1% OF THE CONNECTED LOAD OR AS PER THE STATE /LOCAL BUILDING BYE-LAWS REQUIREMENT, WHICHEVER IS HIGHER.

PROJECT: REVISED PLAN SHOWING ADDITION & ALTERATION OF 6 NOS GROUND + 10 STORED RESIDENTIAL BUILDING AND ONE NO 3 STORED AMENITY BLOCK
NAME OF OWNERS: 1.MEGASUN MERCHANTS PVT. LTD. REPRESENTED BY ONE OF ITS DIRECTOR SRI. KISHAN AGARWAL
2. KAMAL CHAND BOHRA
3. ANAND AGARWAL
4. SUSHIMA AGARWAL
5. UNITED PROPERTIES PVT. LTD. REPRESENTED BY ITS DIRECTOR VEDEVAD BASAK
LOCATION: SISHABARI, SILIGURI

LAND SCHEDULE:
MOUZA: SISHABARI
J.L. NO. 41
L.R. PLOT NO. :357,360,261,256,255,258,258,259
R.S. PLOT NO.: 118,116,116,117,119,120,121
SHEET NO. 01 (L.R.), 01 (R.S.)
KHATIAN NO. 3650,3651,3649,3514,2168 (L.R.)
P.S.: PRADHAN NAGAR
DIST. DARJEELING
Latitude : 26°46'45.00"(N)
Longitude : 88°25'30.33"(E)

AREA STATEMENTS	
1. LAND AREA (AS PER DEED)	: 20234.11 sq.m.
2. LAND AREA (AS PER KHATIAN)	: 2271.87 sq.m.
3. LAND AREA (AS PER SITE)	: 14745.18 sq.m.
4. PERMISSIBLE GROUND COVERAGE	: 9737.59 sq.m. (65%)
5. PROPOSED GROUND COVERAGE	: 7280.82 sq.m. (37.39%)
6. AREA OF PUMP ROOM AT -3150 LVL.	: 152.76 sq.m.

PREVIOUSLY SANCTIONED BUILDING:	
I) BLOCK-1	a. GROUND FLOOR AREA : 1120.62 sq.m.
b. TYPICAL FLOOR(1ST-10TH) AREA (922.95X10)	: 9229.50 sq.m.
II) AMENITY BLOCK	a. GROUND FLOOR AREA : 733.20 sq.m.
b. FIRST FLOOR AREA : 733.20 sq.m.	c. SECOND FLOOR AREA : 241.38 sq.m.
C. PROPOSED BUILDING:	
I) BLOCK-2	a. GROUND FLOOR AREA : 1120.62 sq.m.
b. TYPICAL FLOOR(1ST-10TH) AREA (922.95X10)	: 9229.50 sq.m.
II) BLOCK-3	a. GROUND FLOOR AREA : 1120.62 sq.m.
b. TYPICAL FLOOR(1ST-10TH) AREA (922.95X10)	: 9229.50 sq.m.
III) BLOCK-4	a. GROUND FLOOR AREA : 745.81 sq.m.
b. TYPICAL FLOOR(1ST-10TH) AREA (597.58X10)	: 5975.80 sq.m.
IV) BLOCK-5	a. GROUND FLOOR AREA : 1163.84 sq.m.
b. TYPICAL FLOOR(1ST-10TH) AREA (934.11X10)	: 9341.10 sq.m.
V) BLOCK-6	a. GROUND FLOOR AREA : 764.21 sq.m.
b. TYPICAL FLOOR(1ST-10TH) AREA (610.31X10)	: 6103.10 sq.m.

DECLARATION OF OWNER'S:-
I DO HEREBY DECLARE THAT THE BUILDING PROPOSED FOR CONSTRUCTION SHALL BE SUPERVISED BY THE B.A.L.B.S. SIGNING THE BUILDING PLAN APPLICATION OR IN HIS ABSENCE BY ANY OTHER B.A.L.B.S. OF THE APPROPRIATE CATEGORY AND AS APPROVED BY THE AUTHORITY.
1) Megasun Merchants Pvt. Ltd.
2) Kamal Chandra Bohra
3) Anand Agarwal
4) Sushima Agarwal
5) United Properties Pvt. Ltd.
6) Vedeved Basak

SIGNATURE OF OWNER'S

DECLARATION OF STRUCTURAL ENGINEER
THE STRUCTURAL DESIGN AND DRAWING OF BOTH FOUNDATION AND SUPER STRUCTURE OF THE BUILDING HAS BEEN MADE BY ME CONSIDERING ALL POSSIBLE LOADS INCLUDING THE SEISMIC LOAD AS PER THE "NATIONAL BUILDING CODE" OF INDIA AND CERTIFIED THAT IT IS SAFE AND STABLE IN ALL RESPECT.
MOREOVER I/WE SHALL BE HELD RESPONSIBLE FOR ANY STRUCTURE DAMAGE/FAILURE HAPPENED DURING CONSTRUCTION PERIOD AND THERE AFTER BEYOND DATE OF TAKING OCCUPANCY CERTIFICATE.

SIGNATURE OF STRUCTURAL ENGINEER

DESIGNED AND CHECKED BY ME

SIGNATURE OF GEO-TECHNICAL ENGINEER

DECLARATION OF ARCHITECT / L.B.S.
I DO HEREBY DECLARE THAT THE KEY PLAN, SITE PLAN AND THE BUILDING PLAN HAVE BEEN PREPARED UNDER MY SUPERVISION AND I SHALL BE RESPONSIBLE FOR THE SUPERVISION OF THE BUILDING.

SIGNATURE OF ARCHITECT / L.B.S.

TITLE:- OVERALL GROUND FLOOR PLAN, SITE PLAN, PART PLAN AND SECTION OF FIRE PUMP ROOM, LOCATION PLAN AND AREA STATEMENT.

SCALE:- VARIES
DATE:- 18.09.22
SHEET NO.:- 01
CHK. BY:- K.K.ROY
DRAWN BY:- SAHELI

GREEN ARCHITECTURE CONSULTING ENGINEERS PVT. LTD.
1ST FLOOR, B.R. AMBEDKAR COMPLEX, HILL CART ROAD, SILIGURI - 734003

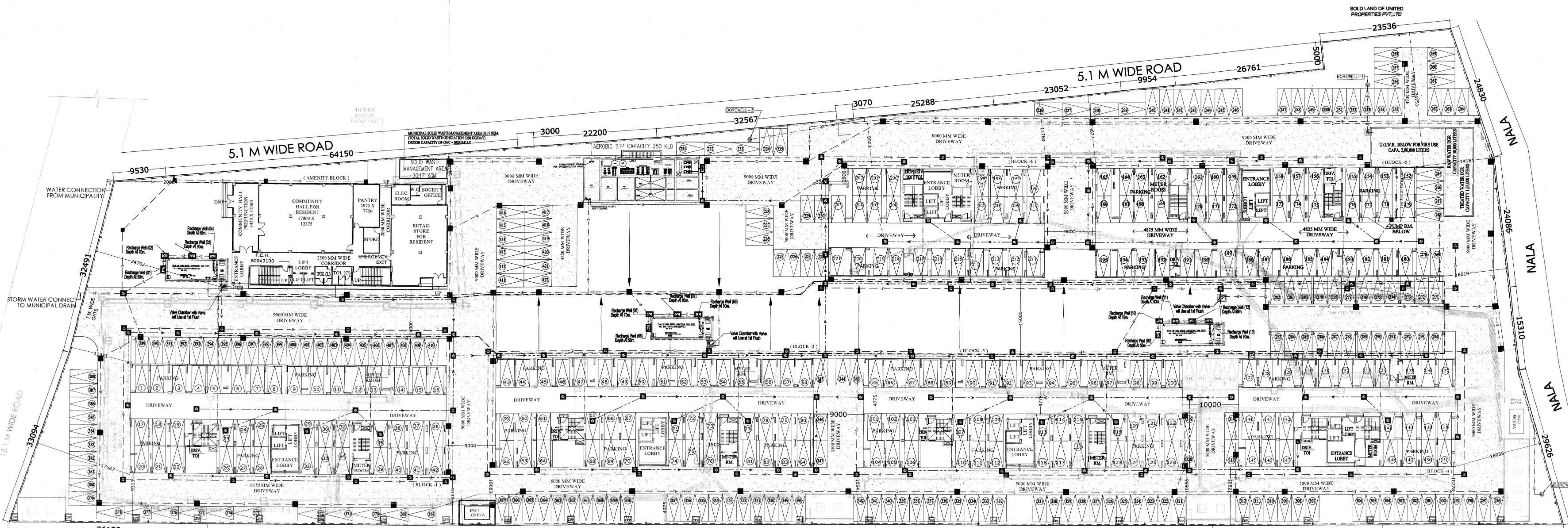

OVERALL GROUND FLOOR PLAN SCALE - 1:300

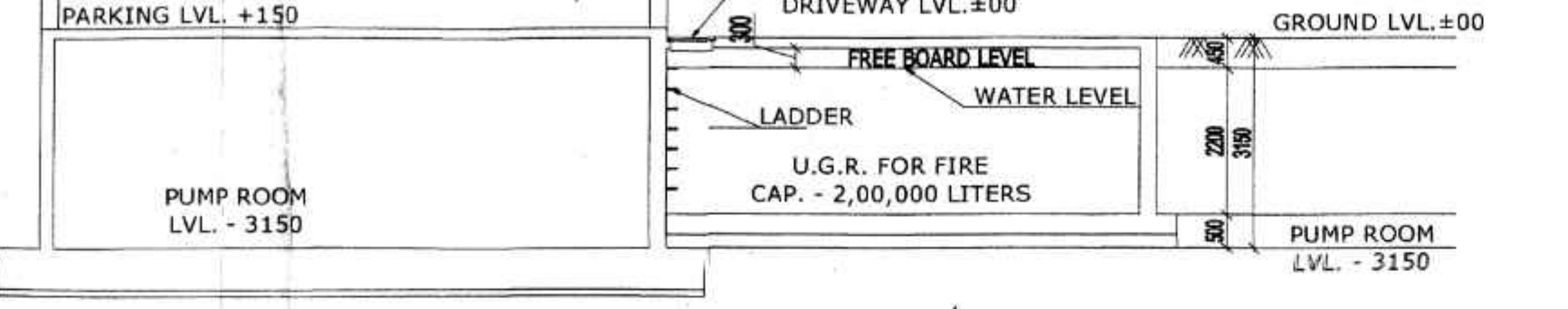

PART SECTION THROUGH P-P SCALE 1:100

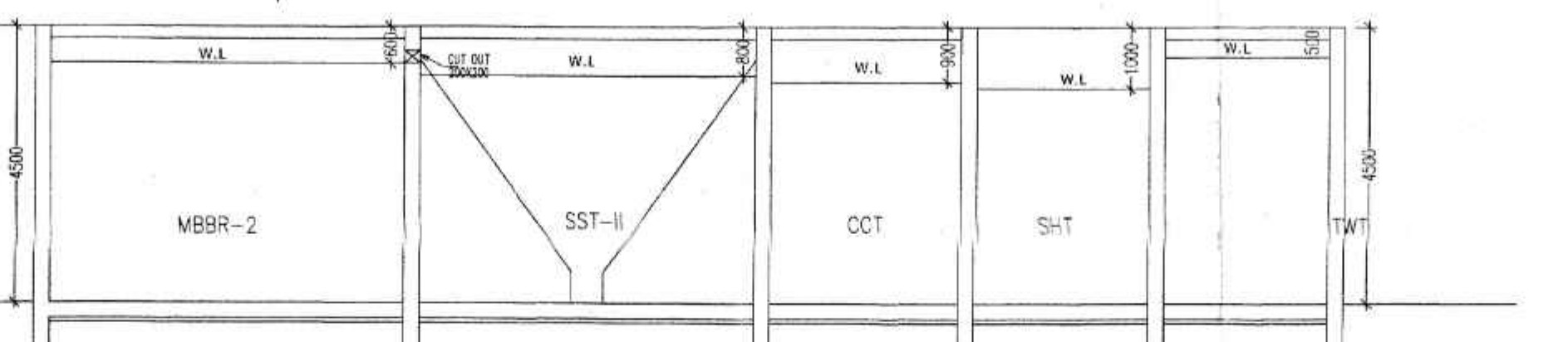

S.T.P. SECTION AA

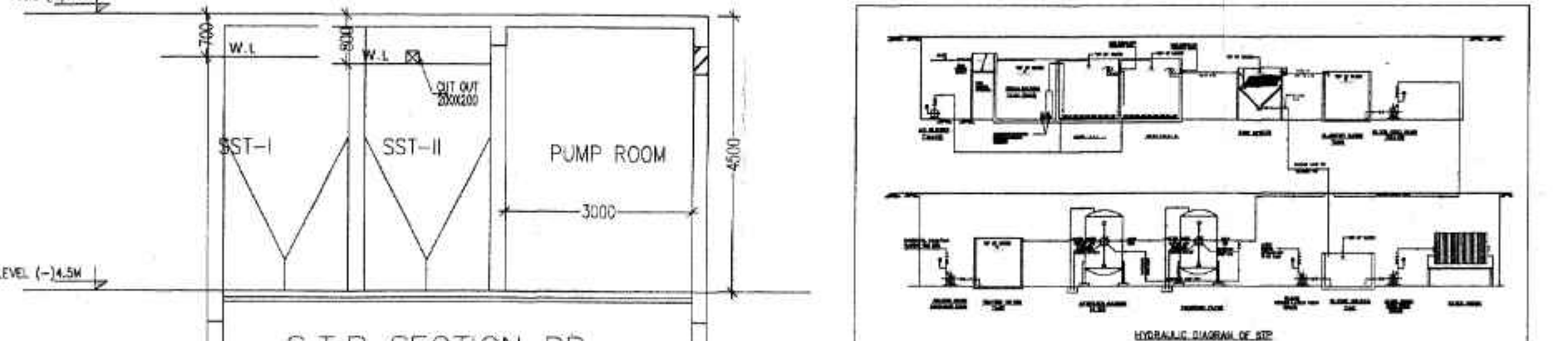

S.T.P. SECTION BB

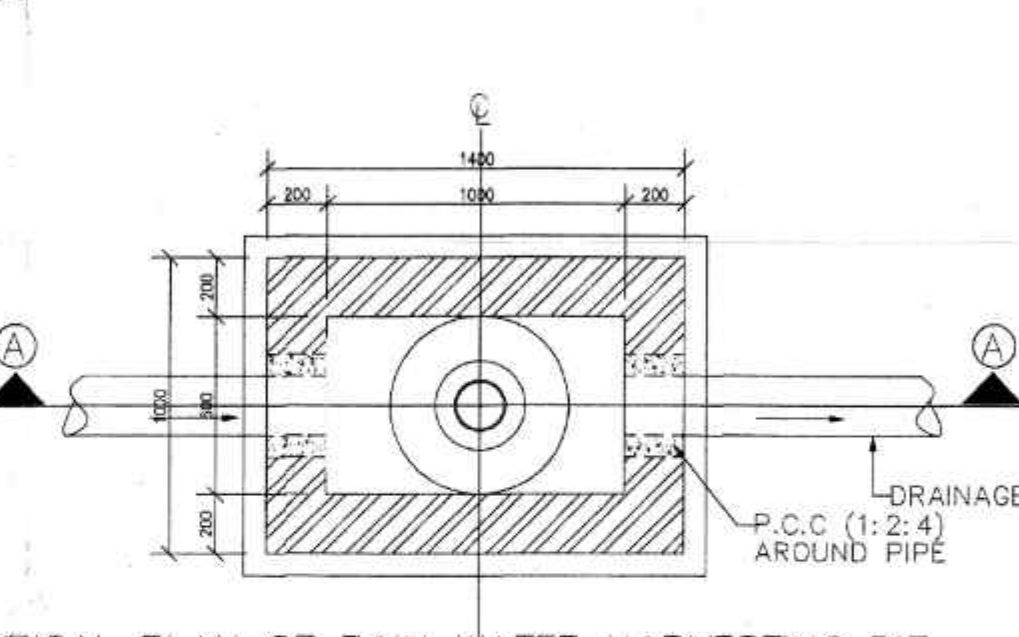

TYPICAL PLAN OF RAIN WATER HARVESTING PIT SIZE- 1000X600MM (CLEAR)

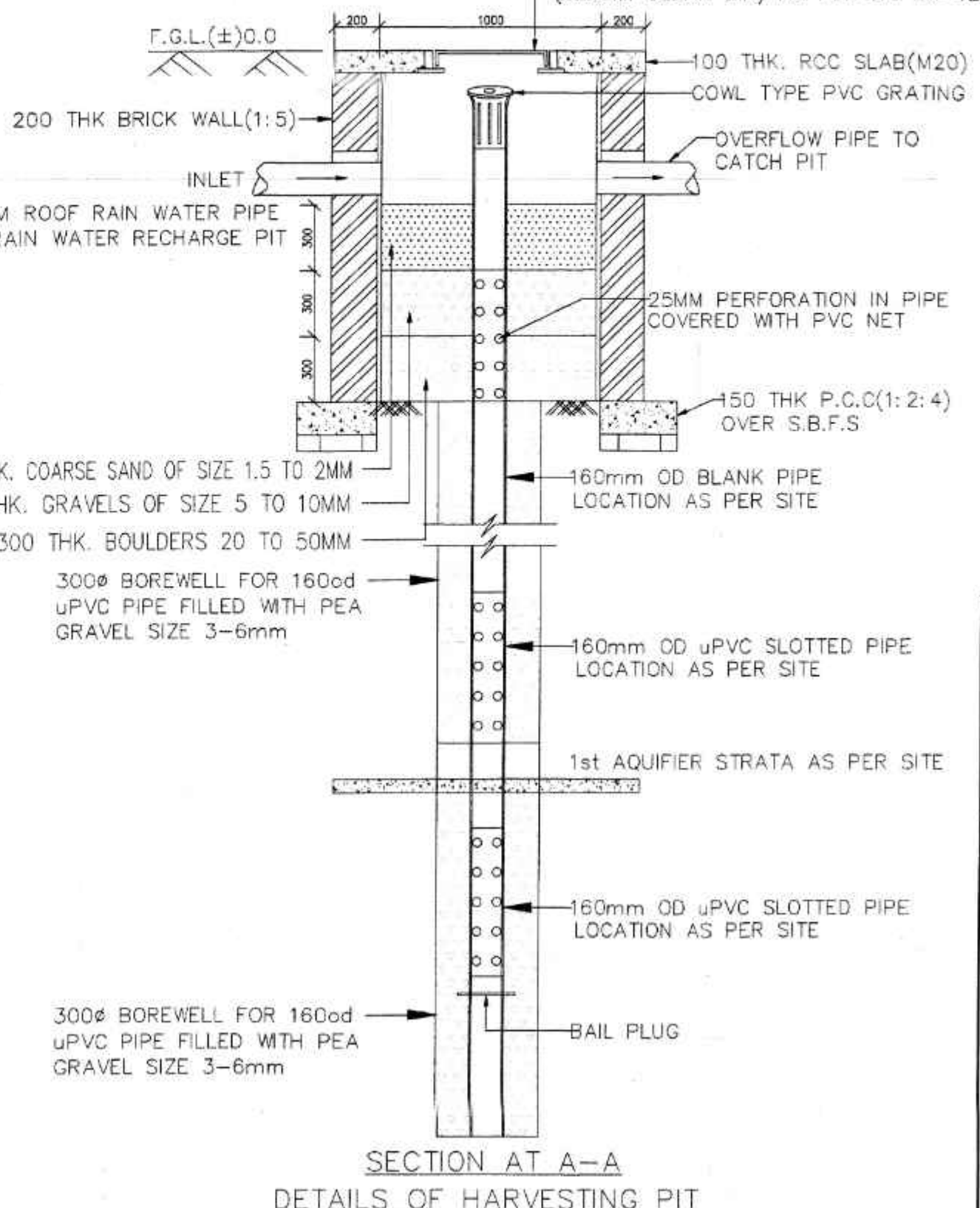

SECTION AT A-A DETAILS OF HARVESTING PIT

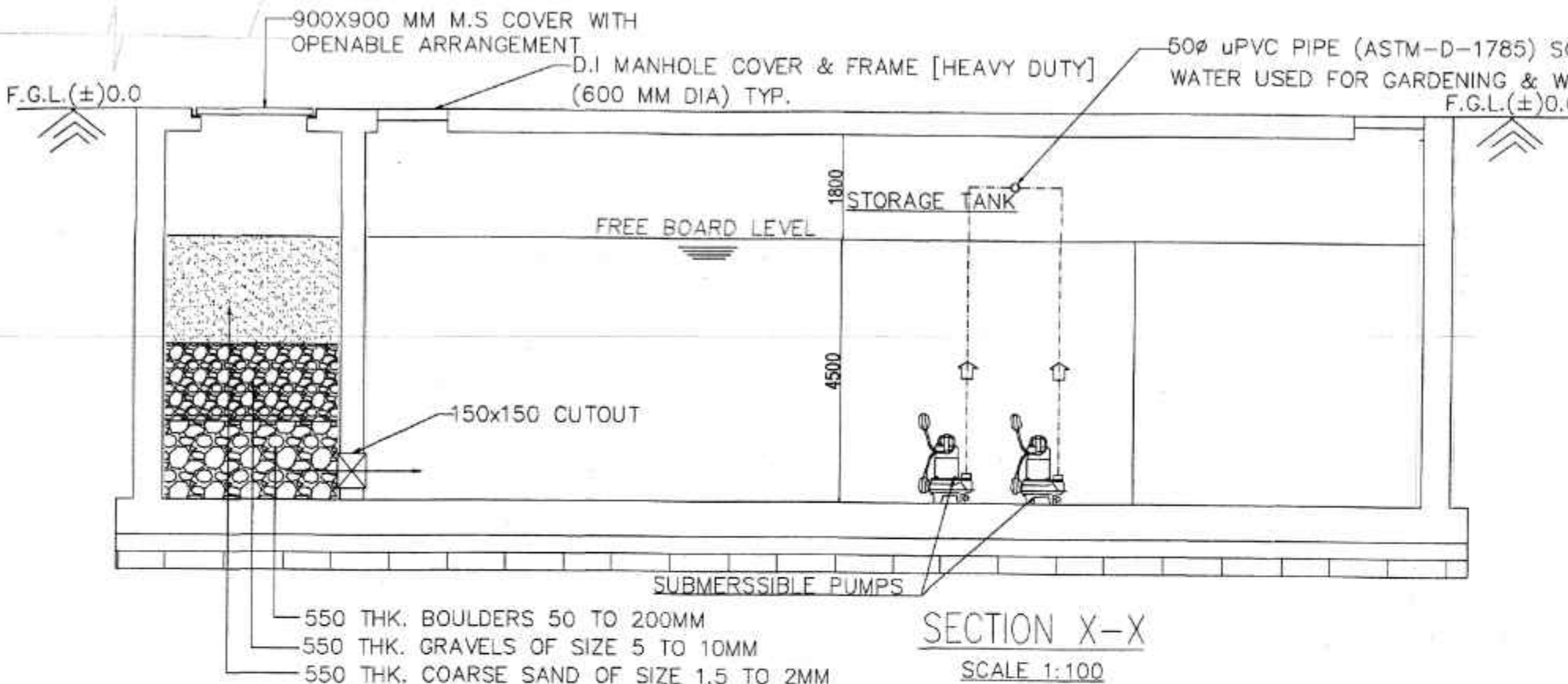

SECTION X-X SCALE 1:100

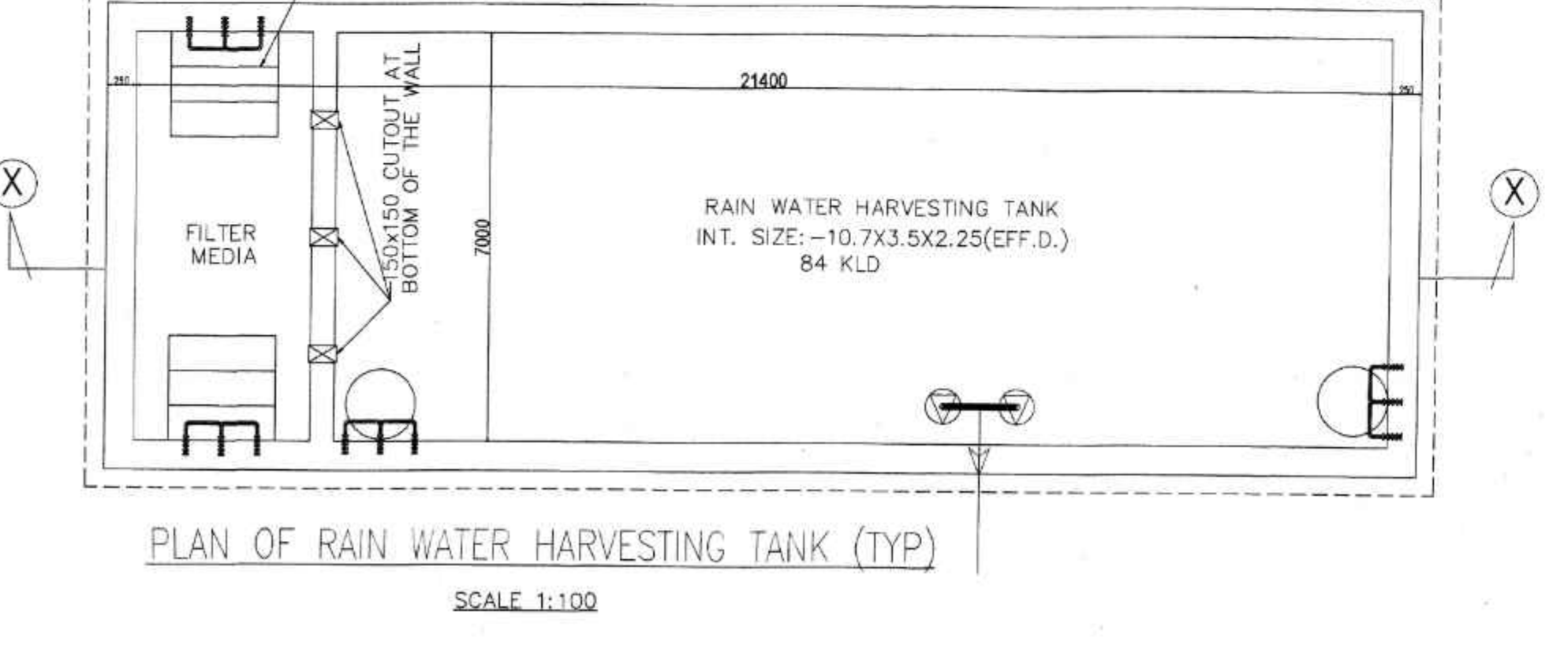

PLAN OF RAIN WATER HARVESTING TANK (TYP) SCALE 1:100

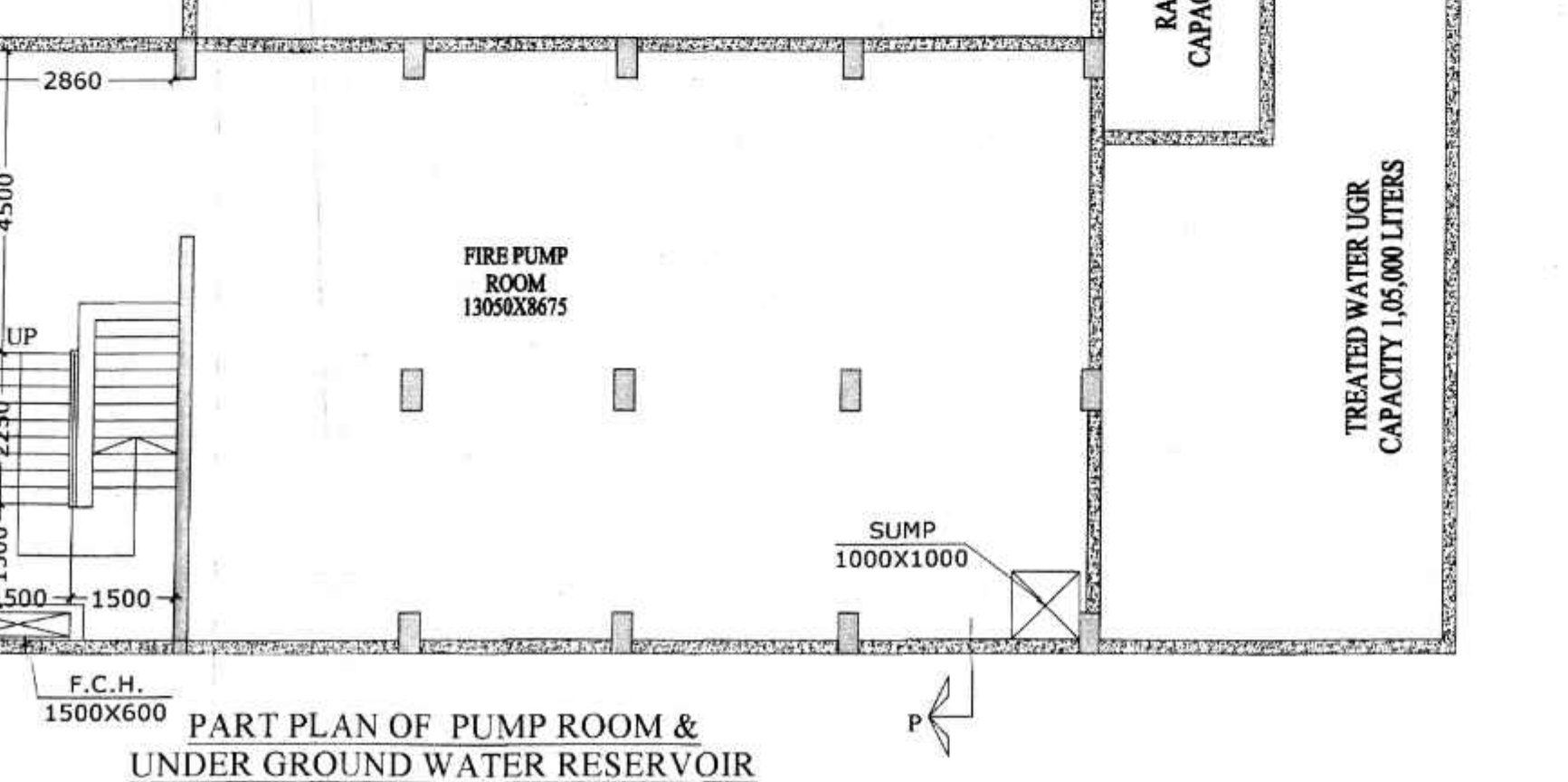

PART PLAN OF PUMP ROOM & UNDER GROUND WATER RESERVOIR SCALE 1:100

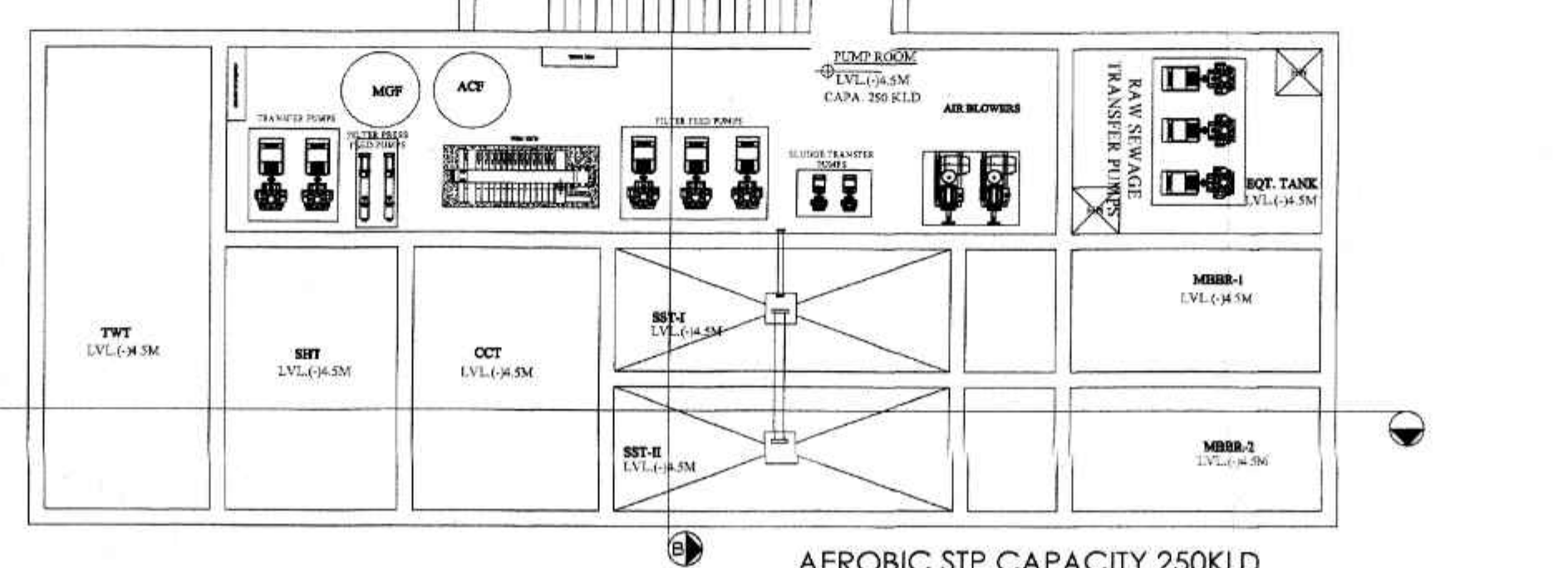

AERobic STP CAPACITY 250KLD

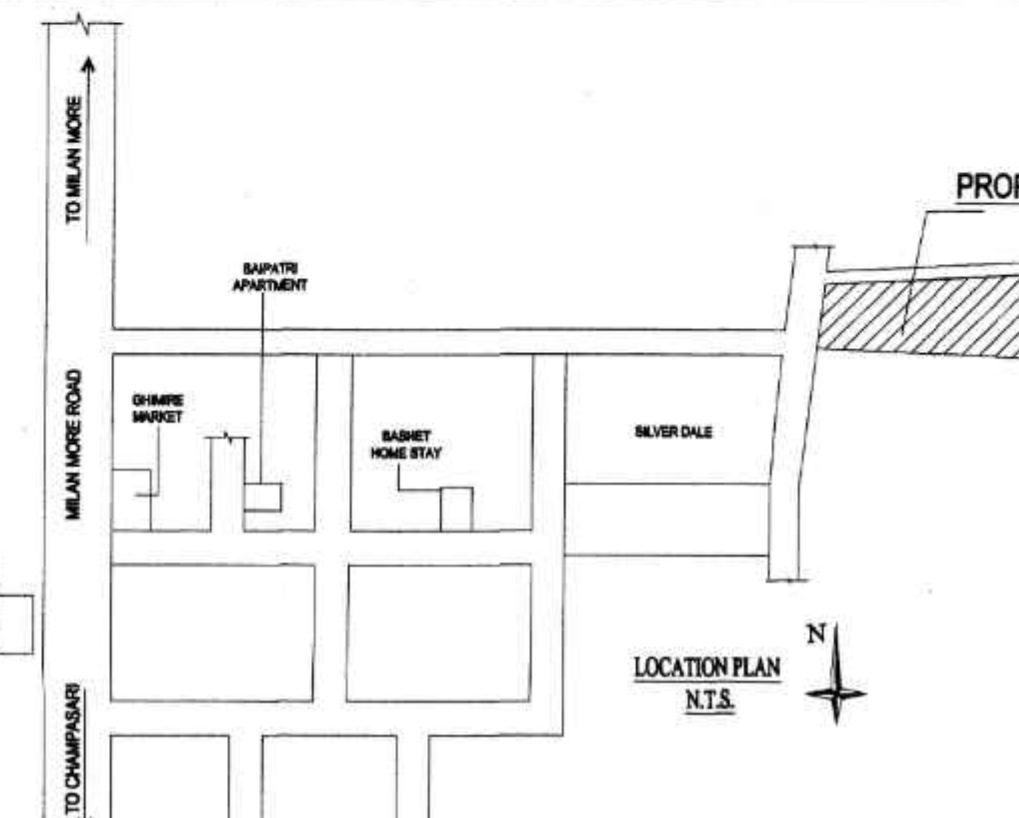

LOCATION PLAN N.T.S.